

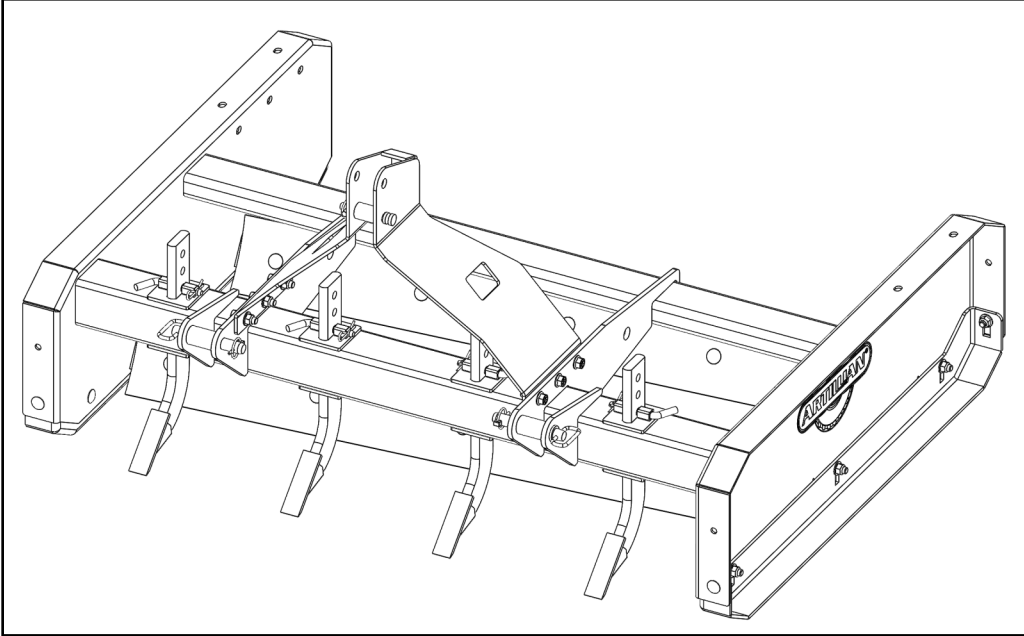

Land Plane, 54"
P/N: 1LP54-XX
 XX denotes paint code: JG = Green, TB = Black, O = Orange



The Artillian Land Plane is the perfect 3-Point hitch implement for Compact and Sub-Compact tractor owners who are looking to smooth out uneven terrain. Made from North American steel and high strength structural steel tubing. The 3/8" thick, curved and double beveled cutting edges are made from high carbon 1084 steel and can be reversed for additional longevity. Adjustable formed and welded skid shoes allow for cutting depths from 0" - 1". Scarifier shanks included for ripping through compacted soil. Optional cinder block holder increases weight by up to an additional 220 pounds. Perfect for maintaining gravel driveways.

Fits 3-Point Hitch (category 1) and is Quick Hitch Compatible. All hitch pins and quick hitch bushings included!

Approximate Installation Time
Experienced Dealer Technician – 15 Minutes
Do-It-Yourself – 30 Minutes

Approximate Product Specifications
Dimensions: 60.5" X 47.25" X 33.25"
Weight: 400 lbs. (not including accessories)

Register your new product quickly online at Artillian.com/product-registration/



Artillian encourages all customers to register their Artillian products. However, failure to do so will not diminish right to warranty. Curtis Industries does not sell or share your information with anyone else.

Download a digital copy of your installation instructions online at Artillian.com/literature/



Artillian strives to continuously improve our products, technical documentation, etc. Therefore, the installation manual for this product may have been updated after your product was packaged. The latest revision of the installation manual can always be found at the website above.

The contents of this envelope are the property of the owner. Leave with the owner when installation is complete.

Safety

1. **Wear gloves** whenever handling attachments. Watch for sharp edges and possible pinching hazards. Steel toe boots, eye protection, and hearing protection are also recommended anytime working around a tractor.
2. **3-point hitches are optimized for speed and power, not necessarily for precise control. Heavy loads can drop very quickly. Make control inputs carefully. TAKE YOUR TIME. PLAN AHEAD. WATCH FOR OBJECTS ABOVE, BESIDE, BELOW, IN FRONT OF, AND BEHIND YOU.**
3. When moving, be aware of objects in your path while turning. This implement adds over 4' to the rear of the tractor. If an object is struck, do not use the system until a complete inspection has been performed.
4. This system should never be used for lifting or moving people.
5. This system should not be used to suspend an object that is to be manipulated by a person. Always use positive support such as a table, chain fall, sawhorses, etc. in the event of a hydraulic failure, load shift, etc.
6. **Check your tire pressure.** You may find that it needs to be increased for use with higher loads.
7. Always wear your seat belt and be sure all ROPS provisions on your tractor are in proper working order and configured to perform as intended.
8. Inspect the Land Plane occasionally for possible unseen damage. Replace any wear parts, as required.
9. **The components of this system are electrically conductive.** Be aware of and avoid any sources of electrical power with this system.
10. All safety guidelines illustrated in your tractor owner's manuals should be observed whenever using an Artillian attachment. In the event of conflicting information found here, defer to the information in your tractor owner's manual.
11. **This product is designed FOR PERSONAL USE ONLY by the original purchaser. It is not to be used for commercial applications such as for rental equipment or commercial construction, for example. Any such use voids warranty.**

Installation

1. Place the land plane in a safe and open environment.

NOTE:

If you are using a quick hitch, skip to step 9 on the next page. If you are using a standard 3-point hitch, continue with step 2 here.

For 3-point hitch setup:

2. Using a tractor with a standard 3-point hitch, back up to the front of the land plane and stop when the ends of the lift arms are approximately one foot away from the land plane.
3. Raise the lift arms such that the left lift arm is at the same height as the corresponding mounting point on the land plane. The three points are indicated with arrows in figure 3.
4. Adjust the right lift arm to also be at the same height as its corresponding mounting point on the land plane.
5. Adjust the width of the lift arms to fit between the two lift arm brackets on the land plane. This should be about 26"-30".
6. Once the lift arms are set, back the tractor up to fit the lift arms between the brackets. Insert the 7/8" diameter X 4.25" long hitch pins with loop grip through the corresponding brackets and through the lower links. Insert the lynch pins into the hitch pins.
7. Adjust the top link of the 3-point hitch on the tractor to line up with the bottom holes on the top portion of the top link mount structure as indicated in figure 3. Use the 3/4" diameter top link pin to secure the top link in place.
8. Once all three links are set, raise the land plane up off the ground using the tractor's 3-point hitch. Proceed to step 14.

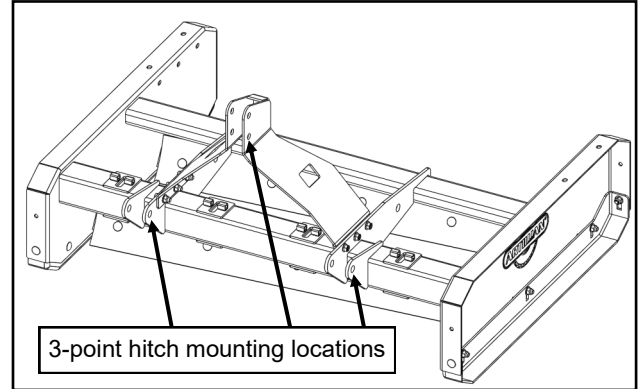

Fig. 3 (3-Point Hitch Mounting Points)

Installation

For quick hitch setup:

9. See figure 9. Assemble the two lift arm bushings onto the land plane. Place the bushing between the two arms and insert the hitch pins from the outside direction of the land plane in.

Hardware Used:

1-7/16" diameter bushing
7/8" diameter hitch pin

QTY:

2
2

10. See figure 10. Repeat the same process with the remaining top link and bushing.

Hardware Used:

1-1/4" diameter bushing
3/4" diameter top link pin

QTY:

1
1

11. Using a tractor with a quick hitch, slowly back the tractor towards the land plane, making sure to back straight towards the land plane.
12. While sitting on the tractor, lower the top hook of the quick hitch to be directly under the top link of the land plane.
13. Once the hitch is under the top link of the land plane, raise the 3-point hitch and the bottom two links will fall into place.

For 3-point hitch and quick hitch setups:

14. Adjust the top link so that the land plane is level when contacting the ground.
15. Continue lifting the land plane until it is at least a foot off the ground.
16. Position a scarifier blade as shown in Figure 16 beneath the main tube of the Land Plane.
17. Slide the Scarifier up through the rectangular opening and insert a bent clevis pin as shown in Figure 17. Secure with the hairpin cotter.
18. Repeat steps 16 and 17 for the remaining three scarifier blades.

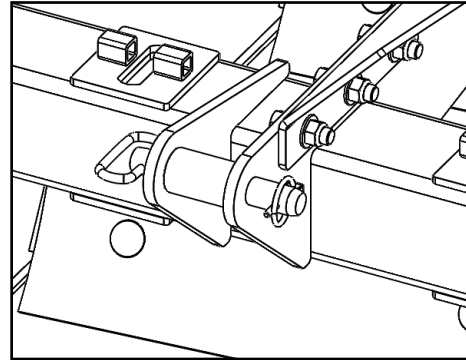

Fig. 9 (Lower link with hitch pin and bushing)

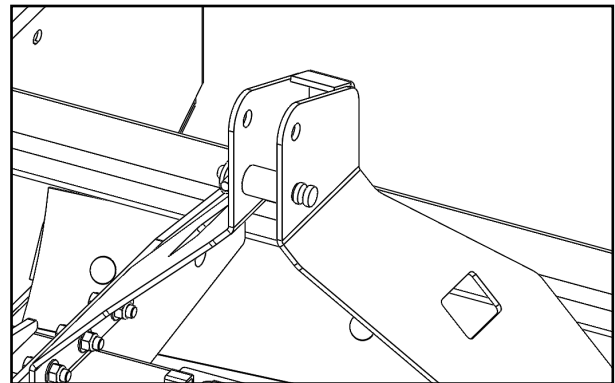

Fig. 10 (Upper link with top link pin and bushing)

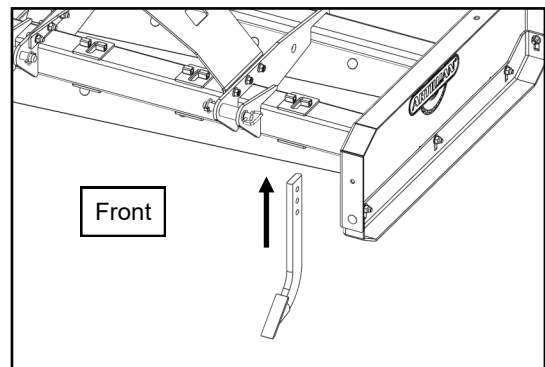

Fig. 16 (Upper link with top link pin and bushing)

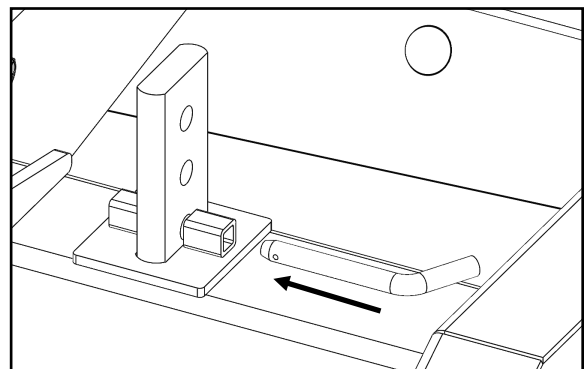

Fig. 17 (Upper link with top link pin and bushing)

1LP54-XX FEATURES & OPERATION

CUTTING DEPTH ADJUSTABILITY

The skid shoes and the scarifiers have adjustability to allow for different depths of cut with the land plane.

To adjust the skid shoes, lift the land plane up using the 3-point hitch on your vehicle. Loosen the five nuts along the bottom that hold each skid shoe to the land plane. Adjust the skid shoe up or down to your desired height. Once the desired height is achieved, refasten the five nuts.

Tip: To ensure the skid shoes stay parallel when adjusting for deeper cutting, rest the land plane on the cutting edges, then slide a board under the skid shoes prior to tightening the fasteners.

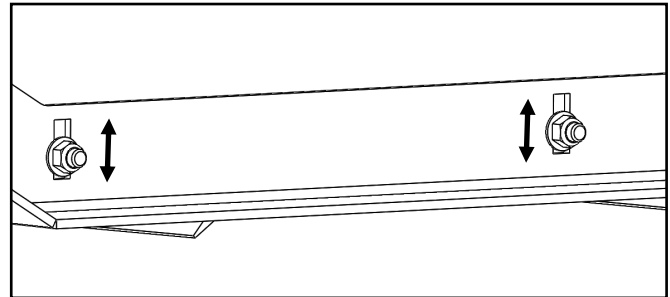

Fig. 11 (Skid Shoe Slots for Adjustment)

In order to adjust the scarifier depth of cut, raise the land plane up using the 3-point hitch. Once there is clearance underneath the land plane, remove the hairpin cotter from the clevis pin, hold the scarifier with one hand, and remove the clevis pin from the scarifier with the other hand. Adjust the scarifier up or down to the desired height and simply insert the clevis pin back into one of the scarifier holes and reinsert the hairpin cotter into the clevis pin.

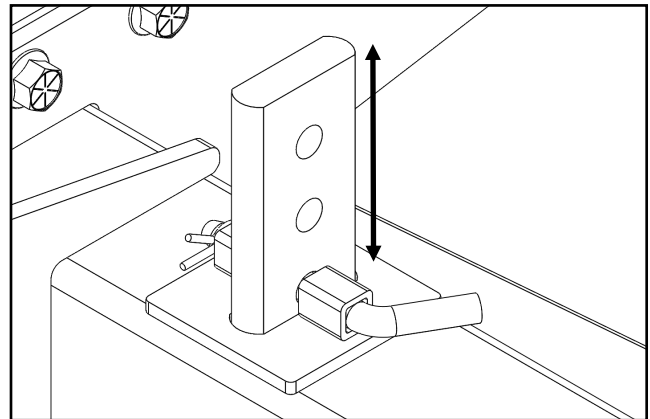
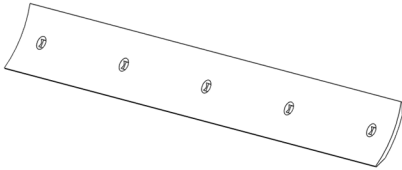

Fig. 12 (Scarifier holes for Adjustment)

LAND PLANE SERVICE PARTS

CUTTING EDGE, 6" X 3/8" X 54" CURVED
P/N: 8SV-9CE-6X375X54-TB



SCARIFIER SHANK, 16", 3 HOLES
P/N: 9SV-9SCF-16
QTY.: ONE

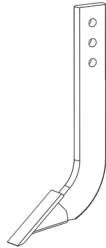

SKID SHOE W/ HARDWARE
P/N: 8SV-SM-03007-JG (GREEN)
P/N: 8SV-SM-03007-TB (BLACK)
P/N: 8SV-SM-03007-O (ORANGE)
QTY.: ONE

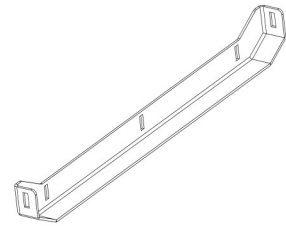

TOP LINK MOUNT
P/N: 8SV-WA-00746-JG (GREEN)
P/N: 8SV-WA-00746-TB (BLACK)
P/N: 8SV-WA-00746-O (ORANGE)

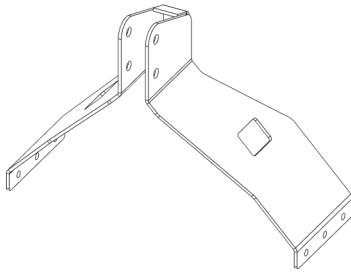

HITCH PIN, 7/8"X4-1/4" W/ PIN
P/N: 9SV-1CP116
QTY.: ONE

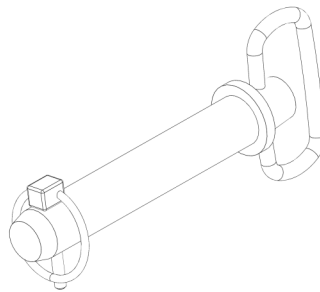

CLEVIS PIN, BENT, 1/2"X3", W/PIN
P/N: 9SV-1CP118
QTY.: ONE

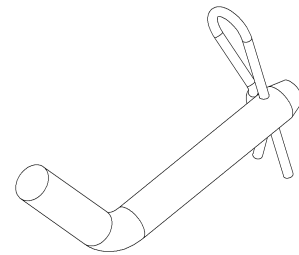

LOWER LIFT ARM REDUCING BUSHING
P/N: 9SV-MP-00110-ZY
QTY.: ONE

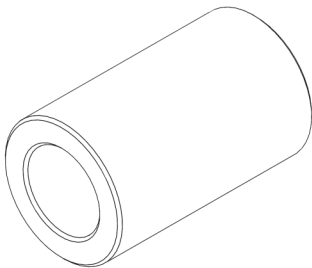

UPPER LIFT ARM REDUCING BUSHING
P/N: 9SV-MP-00109-ZY
QTY.: ONE

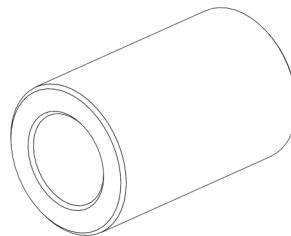

TOP LINK PIN, 3/4"X3" W/ PIN
P/N: 9SV-1CP117
QTY.: ONE

